

ORIGINAL MINI PARTS AND ACCESSORIES. INSTALLATION INSTRUCTIONS.



Union Jack Facelift Rear Lights Retrofit.

MINI Countryman (F60)

Installation instructions only valid for cars before LCI.

Retrofit kit number

63 13 5 A26 BF0 Facelift rear lights retrofit kit

Installation time

The installation time is **approx. 2.25 hours**. This may vary depending on the condition of the car and the equipment in it.

The installation time shown does not include any time spent on programming/coding.

The calculation of the total costs for the programming time must be factored into the calculation of retrofitting costs (must not be invoiced under the warranty).

Important information

These installation instructions are primarily designed for use within the MINI dealership organisation and by authorised MINI service companies.

In any event the target group for these installation instructions is specialist personnel trained on MINI cars with the appropriate specialist knowledge.

All work must be completed using the latest MINI repair manuals, circuit diagrams, servicing manuals and work instructions in a rational order using the prescribed tools (special tools) and observing current safety regulations.

If you experience installation or functional problems, restrict troubleshooting to approx. 0.5 hours for mechanical work and 1.0 hours for electrical work.

To avoid unnecessary extra work and/or costs, please send an inquiry to the technical parts support team.

Quote the following information:

- VIN,
- retrofit kit part number,
- a detailed description of the problem,
- any work already carried out.

Please do not archive the printout of these installation instructions. The current version can be found in the EPC.

Pictograms



Denotes instructions that draw your attention to dangers.



Denotes instructions that draw your attention to special features.



Denotes the end of the instruction or warning text.

Installation information

Ensure that the cables and/or lines are not kinked or damaged as you install them in the car. Costs incurred by this will not be reimbursed by BMW AG.

Additional cables/wires that are installed must be secured with cable ties. If the specified PIN chambers are occupied, bridges, double crimps, or twin-lead terminals must be used.

All illustrations show LHD (left-hand drive) cars; proceed in the same way on RHD (right-hand drive) cars.

After the installation work, the retrofit must be programmed / coded via the **Retrofit** path.

Ordering instructions

The following parts are not supplied in the retrofit kit and must be ordered separately (see EPC for part number and details):

- MQS socket contact **E** (2 x)
- MCON socket contact **E** (2 x)
- GREEN single conductor seal **G** (2 x)
- BLUE/YELLOW cable 0.75 mm² **H** (6 metres)
- BLACK/VIOLET cable 0.75 mm² **I** (4 metres)
- Cable tie **J** (15 x)

Special tools required

Refer to the relevant ISTA/AIR repair manual for details of the special tool required.

Table of contents

Section	Page
1. Parts list for retrofit kit	4
2. Preparatory work	5
3. Connection diagram	6
4. Connecting the Union Jack facelift rear lights	7
5. Concluding work and coding	8

1. Parts list for retrofit kit

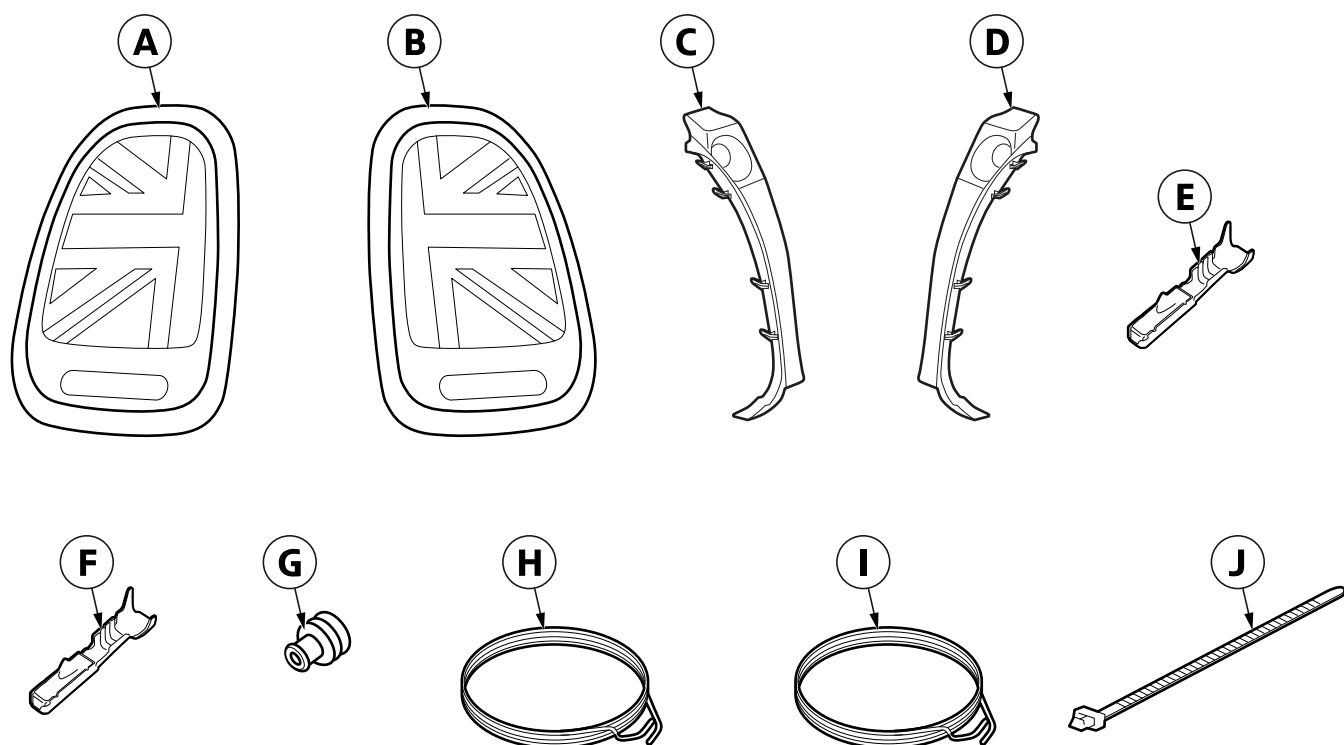

F60 0083 Z

Legend

- A** Left rear light
- B** Right rear light
- C** Left gutter cover
- D** Right gutter cover
- E** MQS socket contact (2 x, not supplied with the retrofit kit)
- F** MCON socket contact (2 x, not supplied with the retrofit kit)
- G** GREEN single conductor seal (2 x, not supplied with the retrofit kit)
- H** BLUE/YELLOW cable 0.75 mm² (6 metres, not supplied with the retrofit kit)
- I** BLACK/VIOLET cable 0.75 mm² (4 metres, not supplied with the retrofit kit)
- J** Cable tie (15 x, not supplied with the retrofit kit)

2. Preparatory work

	ISTA/AIR No.
Disconnect the negative battery cable	61 20 900
The following components must be removed first of all	
Rear light, left and right	63 21 275
Boot wheel arch trim, left	51 47 151
Boot wheel arch trim, right	51 47 161
Cover on bottom right C pillar	51 47 098
Rear right (interior) door sill cover strip	51 47 030
Bottom right B-pillar trim	51 43 150
Front right (interior) door sill cover strip	51 47 000
Bottom right A-pillar trim	51 43 075

3. Connection diagram

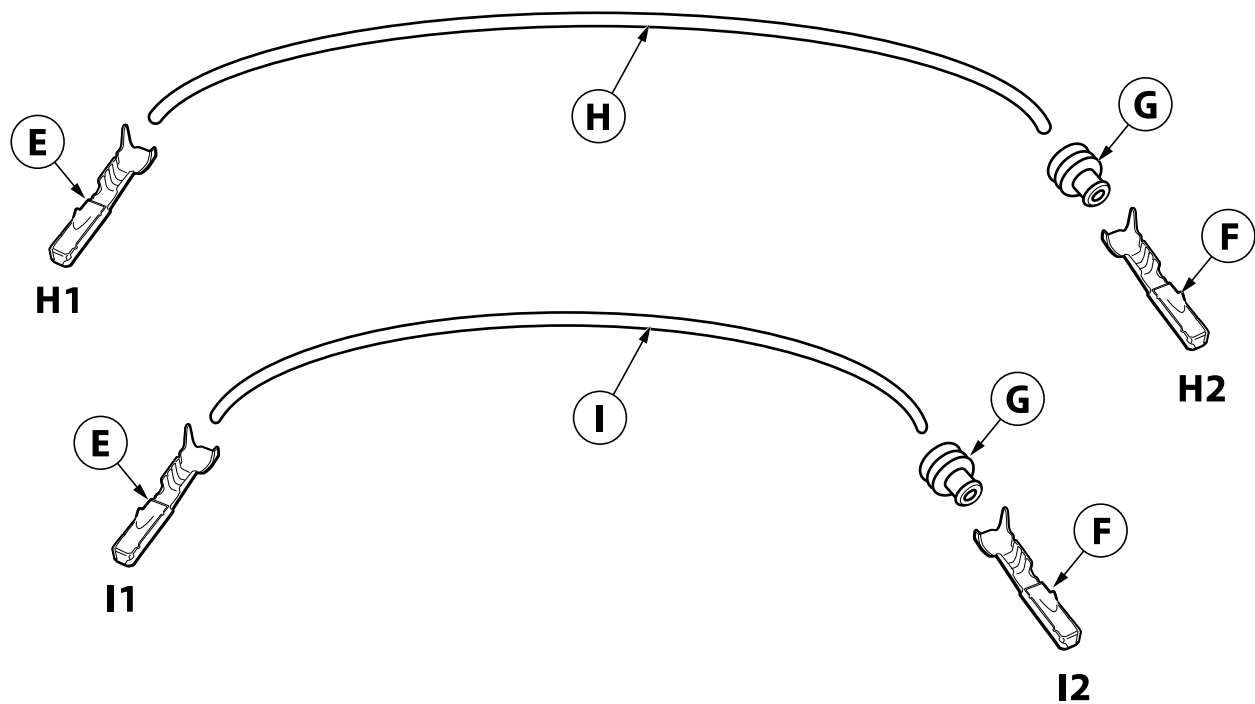

F60 0084 Z

Position	Designation	Signal	Cable colour/ cross-section	Connection location in the car	Abbreviation/ slot
I	BLUE/YELLOW cable	---	---	---	---
I1	Open cable	RFL	BL/GE 0.75 mm ²	With socket contact E to BDC	A258*5B PIN 20
I2	Open cable	RFL	BL/GE 0.75 mm ²	With socket contact F and single conductor seal G to left rear light A	E62*1B PIN 2
H	BLACK/VIOLET cable	---	---	---	---
H1	Open cable	RFS	SW/VI 0.75 mm ²	Socket contact E to BDC	A258*5B PIN 13
H2	Open cable	RFS	SW/VI 0.75 mm ²	With socket contact F and single conductor seal G to right rear light A	E57*1B PIN 5

4. Connecting the Union Jack facelift rear lights

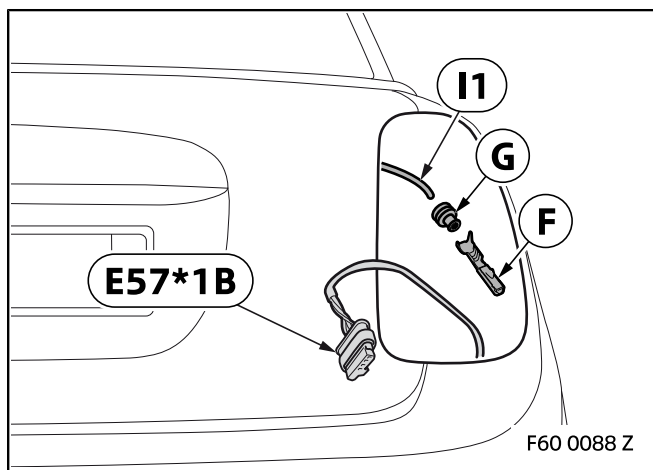
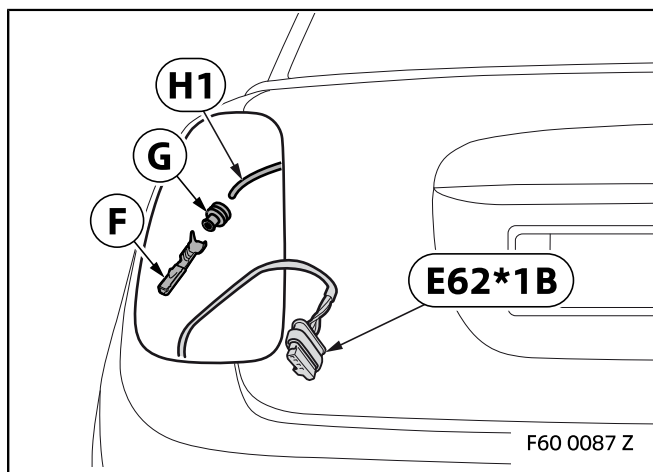
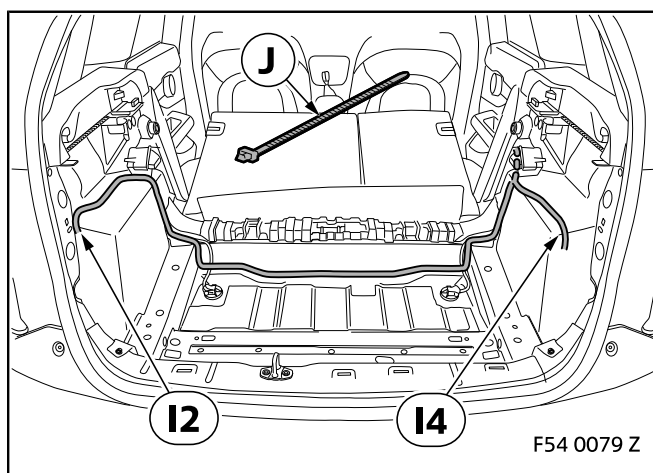
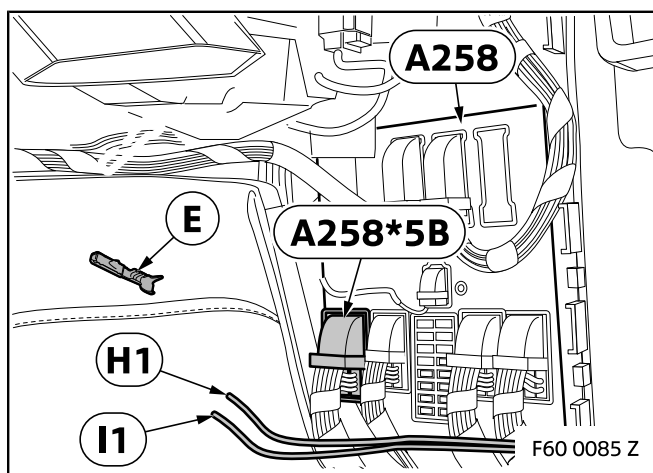

Crimp socket contacts **E** to branch **H1**, BLUE/YELLOW cable, and connect them to PIN 13 in plug **A258*5B** on the BDC **A258**.

Crimp socket contacts **E** to branch **I1**, BLACK/VIOLET cable, and connect them to PIN 20 in plug **A258*5B** on the BDC **A258**.

Route branches **I2** and **H2** along the right-hand side of the car and then further through the boot, as shown, and secure them with cable tie **J**.

Disconnect, insulate and tie back the BROWN cable from PIN 5 on the left rear light plug **E62*1B**.

Disconnect GREY/YELLOW cable from PIN 2 on the left rear light plug **E62*1B** and connect it to PIN 5.

Cut branch **H1**, BLUE/YELLOW cable, to the required length, crimp socket contact **F** with single conductor seal **G** to it and connect it to PIN 2 on the left rear light plug **E62*1B**.

Disconnect, insulate and tie back the BROWN cable from PIN 5 on the right rear light plug **E57*1B**.

Cut branch **I1**, BLACK/VIOLET cable, to the required length, crimp socket contact **F** with single conductor seal **G** to it and connect it to PIN 5 on the right rear light plug **E57*1B**.

5. Concluding work and coding

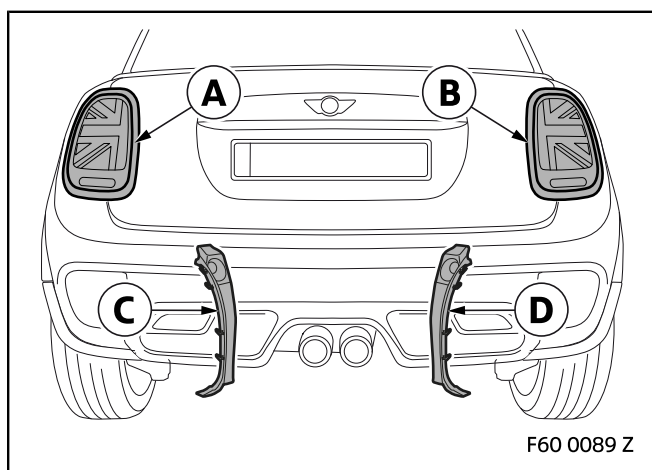

Install rear lights **A** and **B** with left gutter cover **C** and right gutter cover **D** as described in **ISTA/AIR 63 12 275**.

The retrofit system requires programming/coding.

- Connect the battery
- Connect the battery charger to the car
- Connect the car to the ISTA workshop system
- Open the ISTA car programming system
- Please refer to the instructions provided in the ISTA application documentation for working with ISTA
- Select the "LCI rear lights" retrofit in the – **Retrofits** – path and work through the action plan
- If necessary, carry out a vehicle test using the ISTA system, and note, or work through, any errors that have been recorded
- Conduct a function test
- Re-assemble the car